



R.A.P.I.D.[™]
Building Systems

WORLD WIDE HOMES INC.

STEEL FRAMED OFFICE

Portable Office: (10' x 24' – 240 sq. ft.)

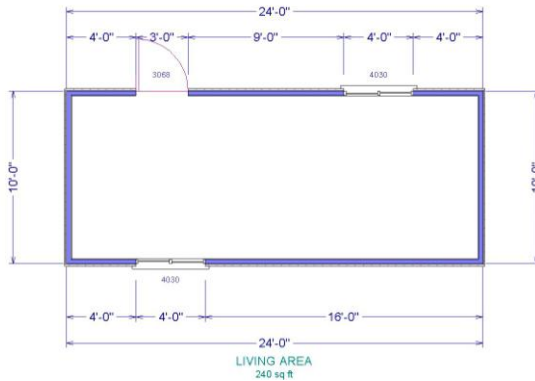

Specifications:

- 10' x 24' building size
- Custom office sizes
- 240 square feet of interior floor space
- Electric, heat and air conditioning
- 100 amp service
- High floor and roof load capacity

Features:

- EPDM roof
- Steel (corrugated) walls
- Steel floor and roof framing
- Steel ceiling rafters
- Steel sub-roof
- Steel stud partition walls
- Insulated walls (R-20), ceilings & floors
- Internet hookups
- Telephone hookups
- 1/8" sheet vinyl floor
- Steel or decorative siding
- Walls – vinyl-covered drywall
- (2) 48" x 36" sliding windows
- Plenty of 120V electrical outlets
- 36" x 80" metal lockable exterior doors
- Fluorescent lighting
- 8' ceiling height
- Individual controls by area for heat and air conditioning

Floor plans may vary. Other sizes, floor plans, configurations and specifications are available. Wood, vinyl and metal exterior, skirting and other customization of features, options and finishes are available upon request such as energy efficient heat pumps, washrooms, kitchens and more.

A variety of code compliant steps are available.

All features noted are **R.A.P.I.D.** Building Systems[™] standards. Specifications may vary by region.

WORLD WIDE HOMES INC.



Features and Benefits of the **R.A.P.I.D. Building System™**

FEATURE

BENEFIT

- | | |
|---|--|
| <ul style="list-style-type: none">• Sturdy corrugated steel frame:
Floor, walls, and roof | <p>Cut down on repairs from transporting and use
No warping, creaking, splitting
No mould, termites, carpenter ants, rodents
Ready for seismic and strong wind forces
Steel will not burn
Longer life span</p> |
| <ul style="list-style-type: none">• Insulation - Roxul & Reflectix | <p>Good R value in hot or cold climates</p> |
| <ul style="list-style-type: none">• Non-flammable & non-toxic insulation | <p>Better health and fire safety</p> |
| <ul style="list-style-type: none">• Green materials - steel & others | <p>Saves trees; recycled materials; better for the environment</p> |
| <ul style="list-style-type: none">• Units are designed for stacking | <p>Less land usage</p> |
| <ul style="list-style-type: none">• Many electrical outlets | <p>Suit your plug-in needs – no extension cords</p> |
| <ul style="list-style-type: none">• Buildings available in a variety of finishes | <p>Match existing buildings and tastes</p> |
| <ul style="list-style-type: none">• Individual thermostat controls | <p>Can heat & cool to individual area needs</p> |